

FLANGES

ASME B16.47 CLASS 300 SERIES B WELDING NECK FLANGES

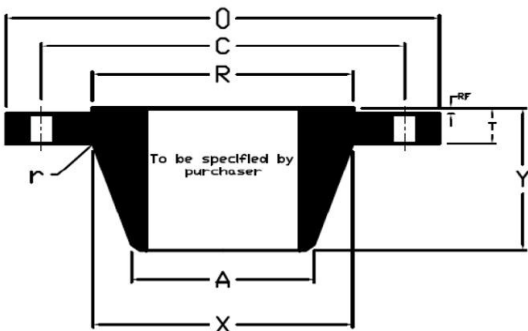

All dimensions are in inches.

These flanges will be supplied with a 1/16" raised face unless otherwise specified.

Flat face option available.

Nominal Pipe Size	Outside Diameter (O)	Minimum Thickness (T)	Raised Face Diameter (R)	Length Thru Hub (Y)	Hub Diameter (X)	Minimum Fillet Radius (r)	Top of Hub (A)	Bore (B)	Approximate Weight (lbs)	Bolt Circle (C)	Number of Holes	Diameter of Holes
inch	inch	inch	inch	inch	inch	inch	inch	inch	lbs	inch	count	inch
26"	34.12"	3.50"	29.00"	5.69"	27.62"	0.56"	26.19"	Specified by Purchaser	400	31.62"	32	1.38"
28"	36.25"	3.50"	31.00"	5.88"	29.75"	0.56"	28.19"		450	33.75"	36	1.38"
30"	39.00"	3.69"	33.25"	6.22"	32.00"	0.56"	30.25"		550	36.25"	36	1.50"
32"	41.50"	4.06"	35.50"	6.62"	34.00"	0.62"	32.25"		685	38.50"	32	1.62"
34"	43.62"	4.06"	37.50"	6.81"	36.12"	0.62"	34.25"		750	40.62"	36	1.62"
36"	46.12"	4.06"	39.75"	7.12"	38.00"	0.62"	36.25"		840	42.88"	32	1.75"
38"	48.12"	4.38"	41.75"	7.56"	40.00"	0.62"	38.25"		915	44.88"	36	1.75"
40"	50.12"	4.56"	43.88"	7.81"	42.00"	0.62"	40.25"		990	46.88"	40	1.75"
42"	52.50"	4.69"	46.00"	8.06"	44.00"	0.62"	42.31"		1135	49.00"	36	1.88"
44"	54.50"	5.00"	48.00"	8.44"	46.19"	0.62"	44.31"		1235	51.00"	40	1.88"
46"	57.50"	5.06"	50.00"	8.75"	48.38"	0.62"	46.31"		1470	53.75"	36	2.00"
48"	59.50"	5.06"	52.25"	8.81"	50.31"	0.62"	48.31"		1575	55.75"	40	2.00"
50"	61.50"	5.44"	54.25"	9.25"	52.38"	0.62"	50.31"		1710	57.75"	44	2.00"
52"	63.50"	5.62"	56.25"	9.56"	54.44"	0.62"	52.31"		1840	59.75"	48	2.00"
54"	65.88"	5.38"	58.25"	9.44"	56.50"	0.62"	54.31"		1980	62.12"	48	2.00"
56"	69.50"	6.06"	60.50"	10.56"	58.81"	0.69"	56.31"		2595	65.00"	36	2.38"
58"	71.94"	6.06"	62.75"	10.81"	60.94"	0.69"	58.31"		2770	67.44"	40	2.38"
60"	73.94"	5.94"	65.00"	10.69"	62.94"	0.69"	60.31"		2870	69.44"	40	2.38"

FLANGES

ASME B16.47 CLASS 300 SERIES B BLIND FLANGES

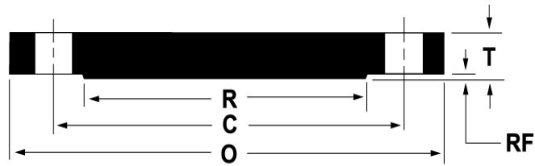

All dimensions are in inches.

These flanges will be supplied with a 1/16" raised face unless otherwise specified.

Flat face option available.

Nominal Pipe Size	Outside Diameter (O)	Minimum Thickness (T)	Raised Face Diameter (R)	Approximate Weight (lbs)	Bolt Circle (C)	Number of Holes	Diameter of Holes
inch	inch	inch	inch	lbs	inch	count	inch
26"	34.12"	3.50"	29.00"	905	31.62"	32	1.38"
28"	36.25"	3.50"	31.00"	1023	33.75"	36	1.38"
30"	39.00"	3.69"	33.25"	1250	36.25"	36	1.50"
32"	41.50"	4.06"	35.50"	1556	38.50"	32	1.62"
34"	43.62"	4.06"	37.50"	1719	40.62"	36	1.62"
36"	46.12"	4.06"	39.75"	1920	42.88"	32	1.75"
38"	48.12"	4.38"	41.75"	2257	44.88"	36	1.75"
40"	50.12"	4.56"	43.88"	2550	46.88"	40	1.75"
42"	52.50"	4.69"	46.00"	2875	49.00"	36	1.88"
44"	54.50"	5.00"	48.00"	3305	51.00"	40	1.88"
46"	57.50"	5.12"	50.00"	3766	53.75"	36	2.00"
48"	59.50"	5.31"	52.25"	4183	55.75"	40	2.00"
50"	61.50"	5.50"	54.25"	4629	57.75"	44	2.00"
52"	63.50"	5.68"	56.25"	5096	59.75"	48	2.00"
54"	65.88"	5.88"	58.25"	5679	62.12"	48	2.00"
56"	69.50"	6.18"	60.50"	6642	65.00"	36	2.38"
58"	71.94"	6.38"	62.75"	7347	67.44"	40	2.38"
60"	73.94"	6.56"	65.00"	7980	69.44"	40	2.38"